

YE-147XB DIN CABLE PLUG METAL SHIELD ASS'Y

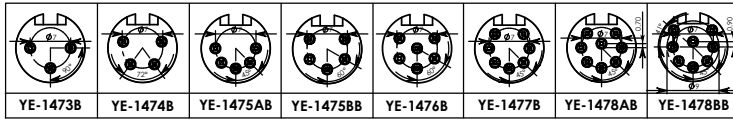
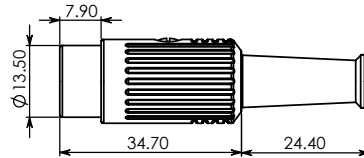
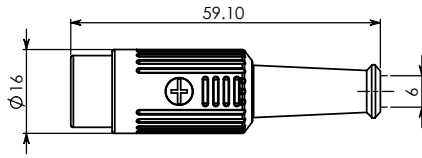

MATERIAL :

1. SHELL COVER : Zn ALLOY CHROME PTD.
2. STRAIN BOOT : TPR
3. SET SCREW: STEEL NICKEL PTD.
4. "T" HOLDER: STEEL NICKEL PTD.
5. HOUSING : PA66
6. TERMINALS : BRASS SILVER PTD.

SPECIFICATION :

- Rating : 100V AC 1A max.
 Contact Resistance :
 Pins 30mΩ max.
 Shell 50mΩ max.
 Insulation Resistance :
 100MΩ at 500V DC min.
 Voltage Withstand :
 250V AC for 1 minute



YE-1473B



YE-1474B



YE-1475AB



YE-1475BB



YE-1475CB



YE-1476B



YE-1477B



YE-1478AB



YE-1478BB